



RELEASE
01

**CLAMPS,
CABLECROSS & RIGGING HARDWARE**

Clamps

Versatility

LITEC presents a new and renovated clamps line to manage any type of installation. They stand out for their design and innovative performances. They are divided in 8 series: ALI4251, ALI4251 NARROW, ALI4851, ALI4851 NARROW, ALI4851 SLIM, ALI6063, LIC3851 and LIC4851. To identify them we have used a micro-percussion technology which reports the family series number and the indication of the safe working load.

They are all made from ultra-high tensile aluminium alloy and their surface is highly polished. On request they can also be supplied with black powder coating finishing.

ALI4251	2
ALI4251N	2
ALI4851	3
ALI4851N	6
ALI4851S	7
ALI6063	8
LIC3851	10
LIC4851	11
Clamps line	12
H Frame	12

ALI4251

This line includes all "the truss clamps" designed for tubes from 42 to 51 mm. Truss clamps are all supplied with M12 wing nuts.



HCL5111F

ALI4251 FLAT
SWL 780 kg

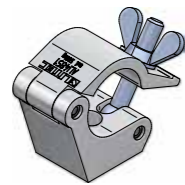
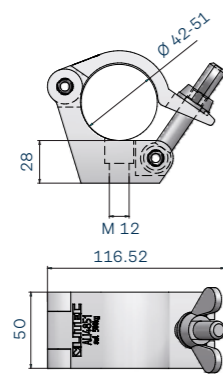

HCL5102F

ALI4251 FL M12/35
SWL 780 kg

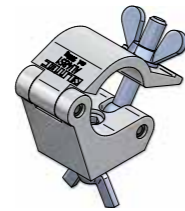
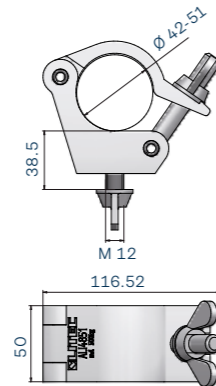

HCL51L01F

ALI4251 FL. 1/2 SP.
SWL 780 kg

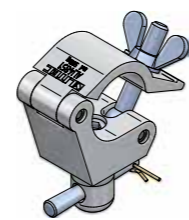
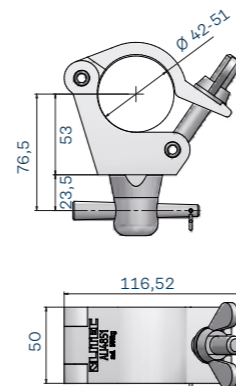

ALI4851

This line includes all "the truss clamps" designed for tubes from 48 to 51 mm. Truss clamps are all supplied with M12 wing nuts.



HCL5101

ALI4851
SWL 650 kg

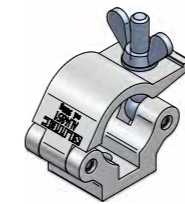
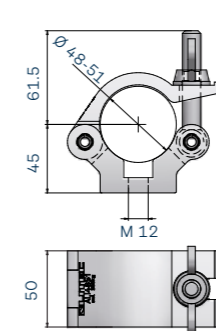

HCL5102

ALI4851 M12/35
SWL 650 kg

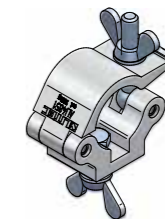
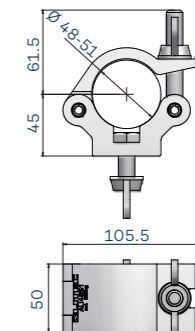

HCL51L01

ALI4851 1/2 SPIGOT
SWL 650 kg

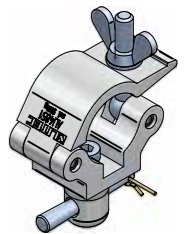
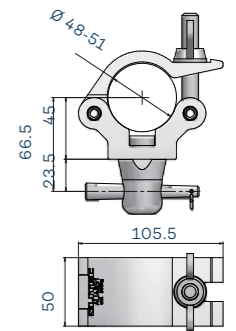

ALI4251N

This line includes all "the NARROW truss clamps" designed for tubes from 42 to 51 mm. Truss clamps are all supplied with M12 wing nuts.



HCL5112FN

ALI4251 FLAT N
SWL 410 kg

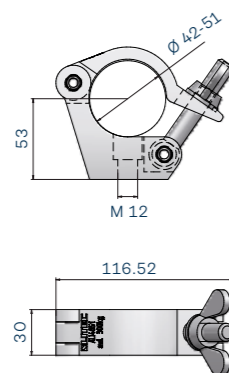

HCL5102FN

ALI4251 FL. N. M12/35
SWL 410 kg

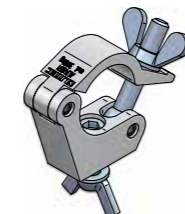
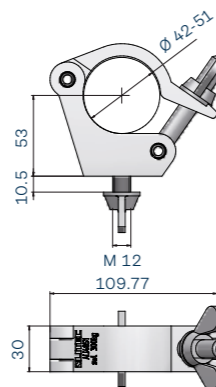

HCL51L01FN

ALI4251 FL. N. 1/2 SP.
SWL 410 kg

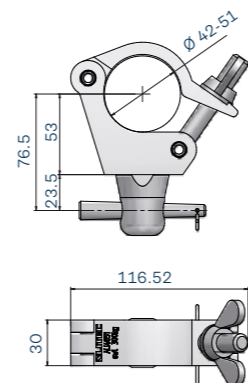

HCL51L02

ALI4851 FORK ADJ
SWL 650 kg

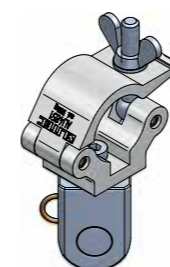
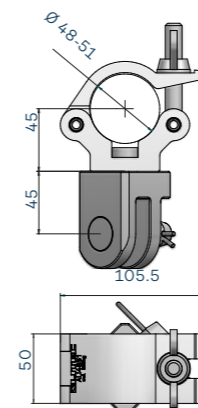

HCL51L03

ALI4851 FORK FIXED
SWL 650 kg

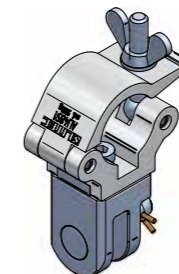
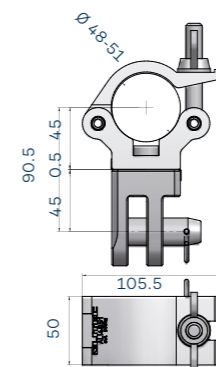

HCL5103W050

ALI4851 LIFT.EYE
SWL 650 kg

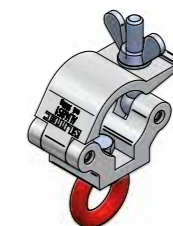
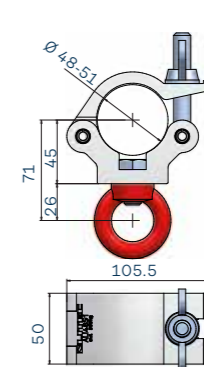

HCL5104

ALI4851 SWIVEL
SWL 540 kg

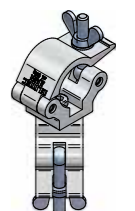
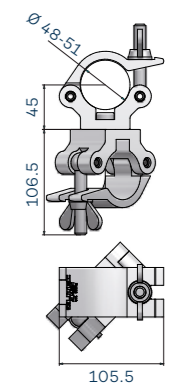

HCL5105

ALI4851 90° FIXED
SWL 540 kg

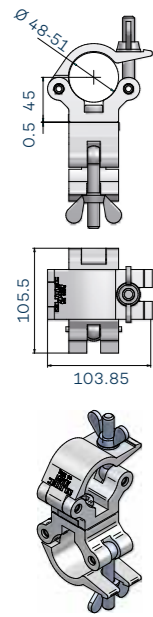

HCL5106

ALI4851 PARALLEL
SWL 540 kg

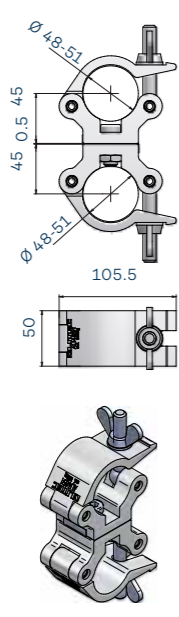

HCL516304

ALI4851-ALI6063
SWIVEL SWL 540 kg

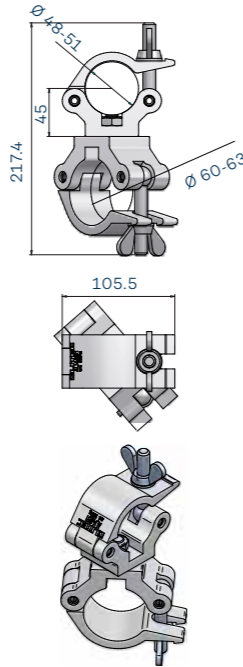

HCL516305

ALI4851-ALI6063
90° FIXED SWL 540 kg

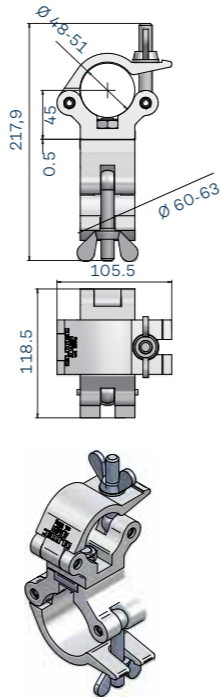

HCL51PC

ALI4851 Panel clamp
for easy clamping (5
mm - 8 mm)

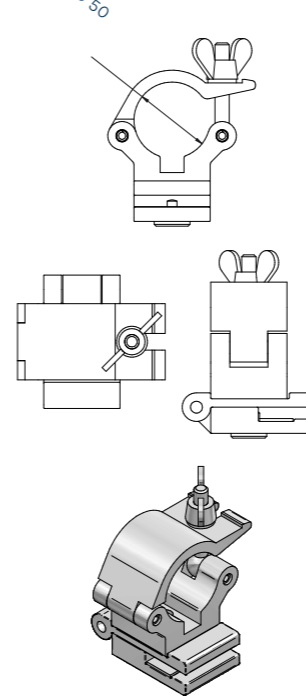

HCL51CL

ALI4851 Clamp for
cladding of the entire
structure

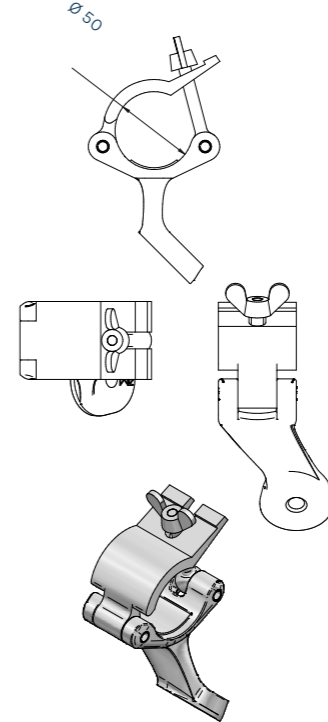

HCL51CL

applications

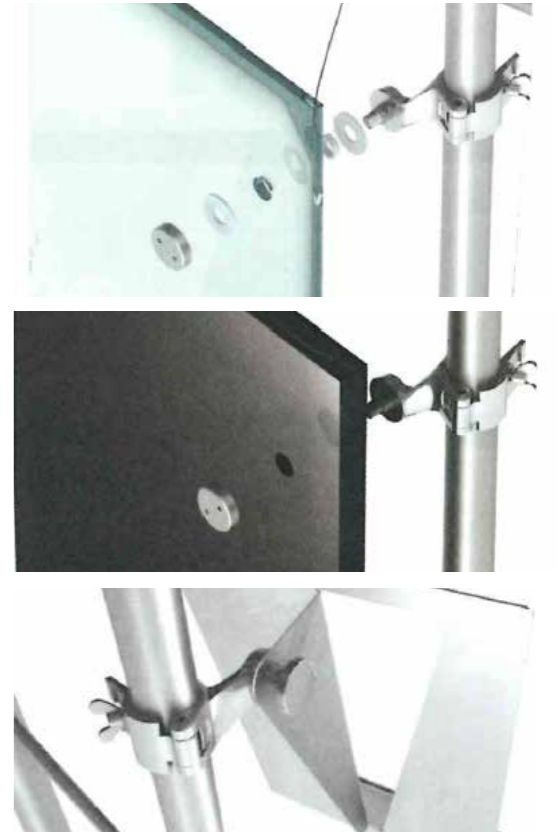

HCL516306

ALI4851-ALI6063
PARALLEL SWL 540 kg

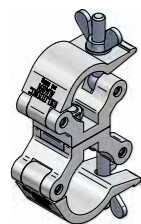
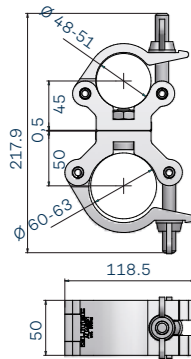

HCL51L07

ALI4851 28 SP.
Truss Support 25-30

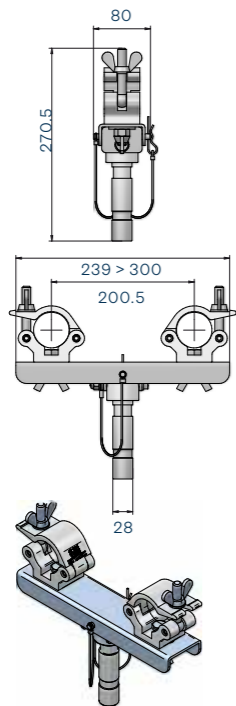

HCL51L08

ALI4851 28 SP.
Truss Support 30-40

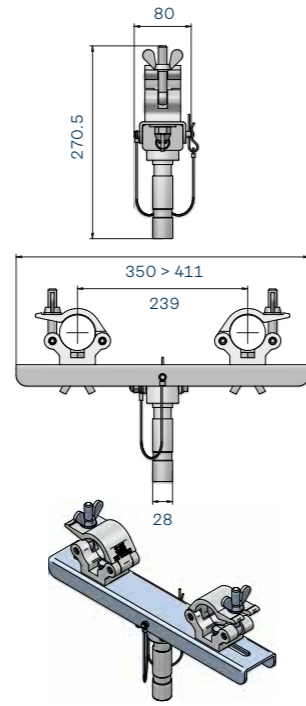

ALI4851N

This line includes all “the NARROW truss clamps” designed for tubes from 48 to 51 mm. Truss clamps are all supplied with M12 wing nuts.



HCL5107N

ALI4851 NARROW
SWL 560 kg

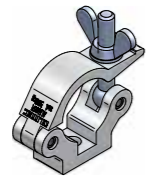
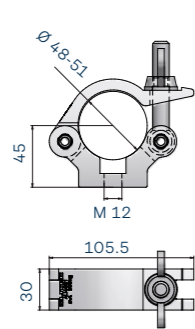

HCL5108N

ALI4851 N. M12/50
SWL 560 kg

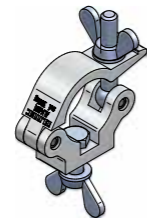
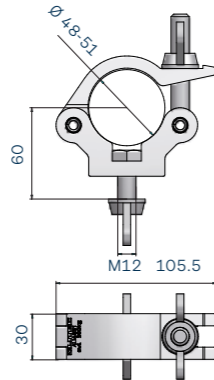

HCL51L01N

ALI4851 N. 1/2 SP. SWL
560 kg

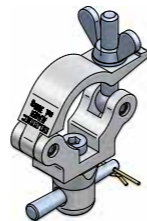
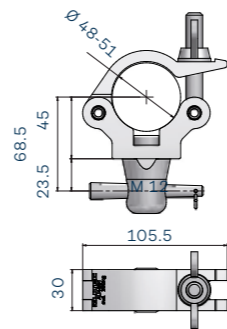

ALI4851S

This line includes all “the SLIM truss clamps” designed for tubes from 48 to 51 mm. Truss clamps are all supplied with M10 wing nuts.



HCL5101S

ALI4851
SL. SWL 230 kg

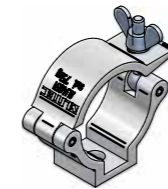
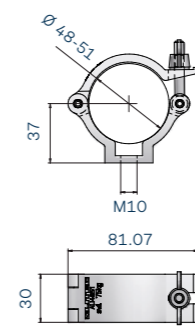

HCL5102S

ALI4851 SL. M10/30
SWL 230 kg

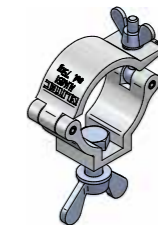
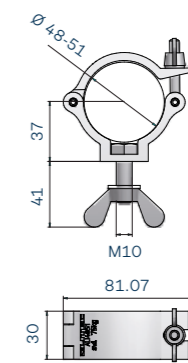

HCL51L01S

ALI4851 SL. 1/2 SP.
SWL 230 kg

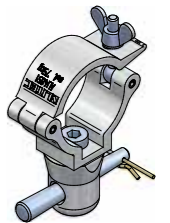
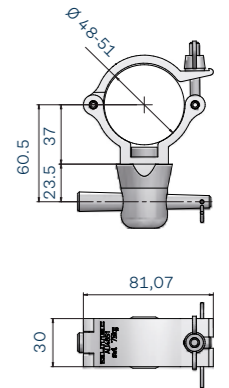

HCL51L02N

ALI4851 N. FORK ADJ.
SWL 560 kg

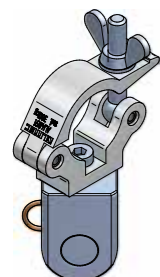
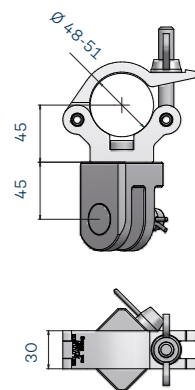

HCL51L03N

Truss clamp ALI4851 N.
FORK FIXED swl 560 kg

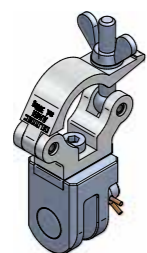
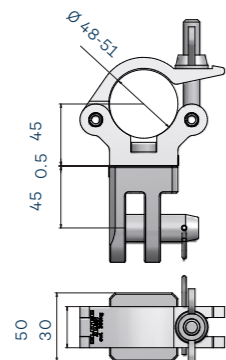

HCL5103W030N

ALI4851 LIFT. EYE
SWL 300 kg

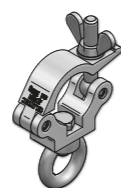
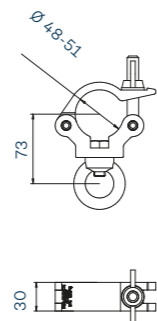

HCL5104N

ALI4851 SWIVEL
SWL 540 kg

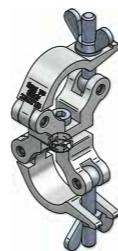
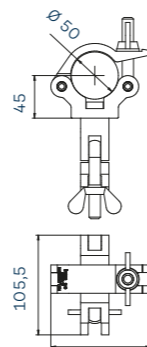

HCL5111S

ALI4851 SL. P.H.
SWL 230 kg

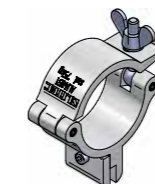
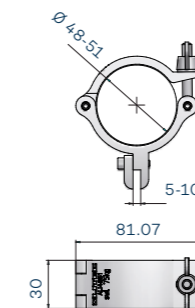

HCL5104S

ALI4851 SL. SW.
SWL 230 kg

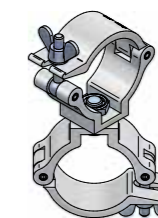
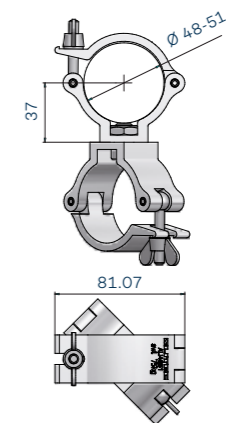

ALI6063

This line includes all "the truss clamps" designed for tubes from 60 to 63.5 mm. Truss clamps are all supplied with M12 wing nuts.



HCL6301

ALI6063
SWL 650 kg

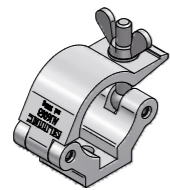
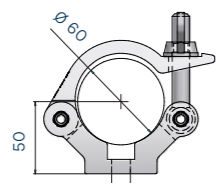

HCL6302

Truss clamp ALI6063
M12/35 SWL 650 kg

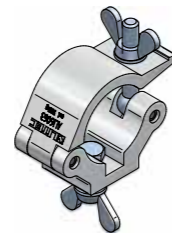
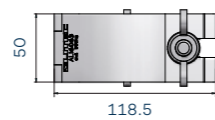
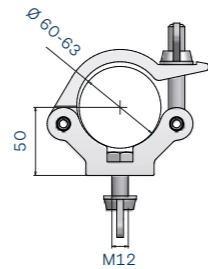

HCL6303W034

Truss clamp ALI6063
LIFT. EYE SWL 340 kg

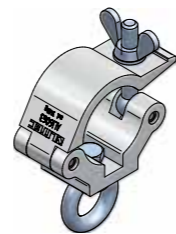
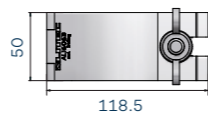
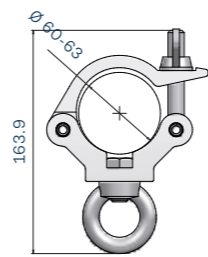

HCL6303W050

Truss clamp ALI6063
LIFT. EYE SWL 650 kg

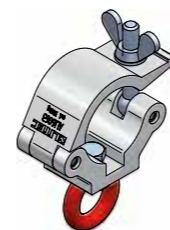
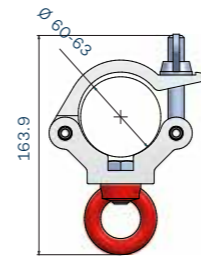

HCL6304

Truss clamp ALI6063
SWIVEL SWL 650 kg

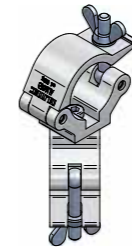
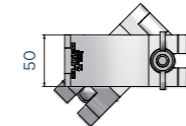
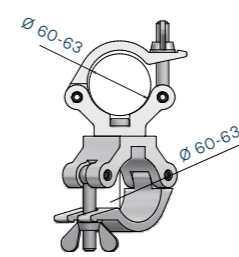

HCL6305

ALI6063 90° FIXED
SWL 650 kg

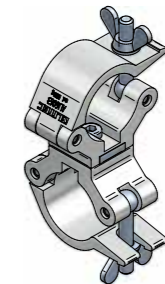
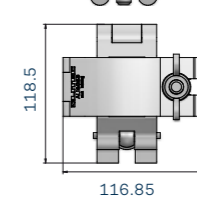
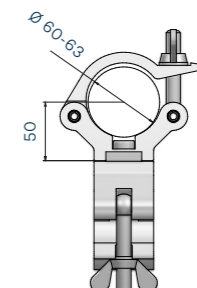

HCL6306

ALI6063 PARALLEL
SWL 650 kg

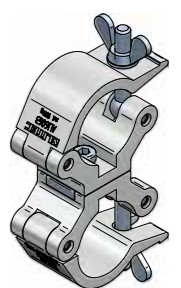
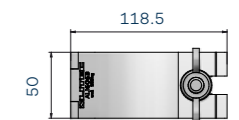
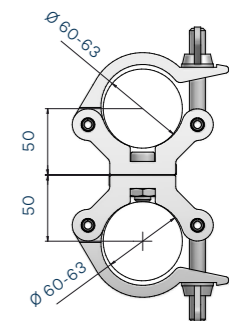

HCL63L01

Truss clamp ALI6063
1/2 SPIGOT SWL
650 kg

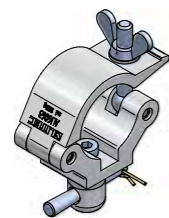
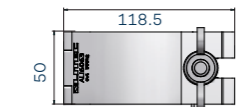
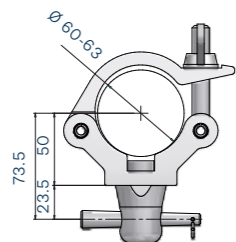

HCL63L02

Truss clamp ALI6063
FORK ADJ. SWL 650 kg

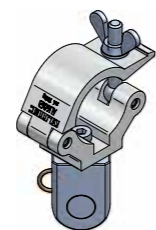
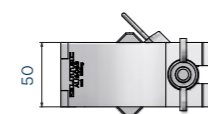
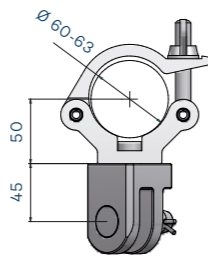

HCL63L03

Truss clamp ALI6063
FORK FIXED SWL
650 kg

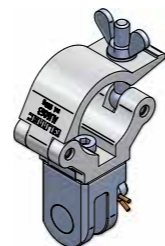
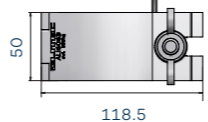
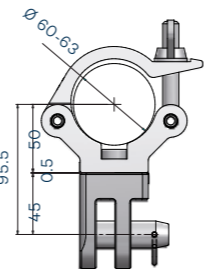

LIC3851

LIC3851 identifies a clamping range of products. This line includes all “the lighting clamps” to hang luminaires onto trusses with tubes with a diameter from 38 to 51 mm. Lighting clamps are all supplied with M12 wing nuts.



ACL51010

Truss clamp LIC3851
OP. swl 360 kg

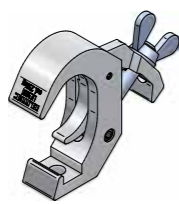
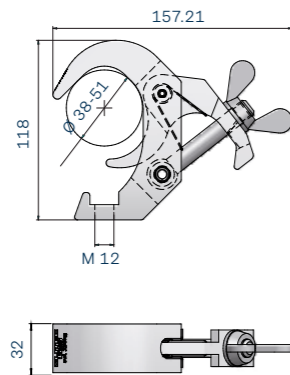

ACL51020

Truss clamp LIC3851
OP. M12/35 swl 360 kg

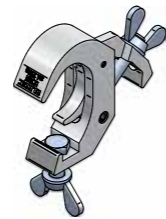
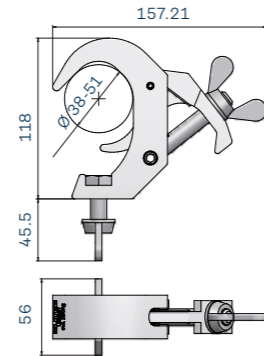

ACL51030

Truss clamp LIC3851
OP. LIFT. EYE swl 360 kg

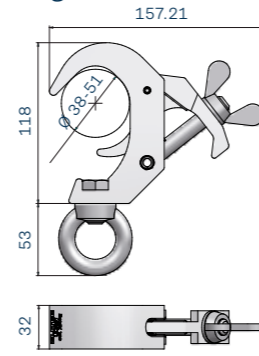

LIC4851

This line includes all “the lighting clamps” to hang luminaires onto trusses with tubes with a diameter from 48 to 51 mm. These lighting clamps are all supplied with knobs.



ACL5101C

Truss clamp LIC4851
CL. swl 350 kg

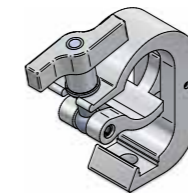
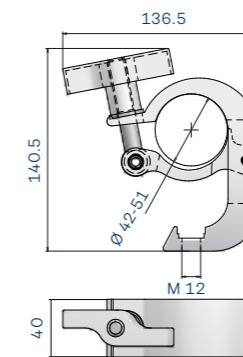

ACL5102C

Truss clamp LIC4851
CL. M12/35 swl 350 kg

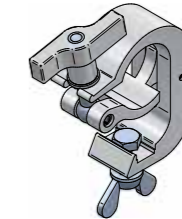
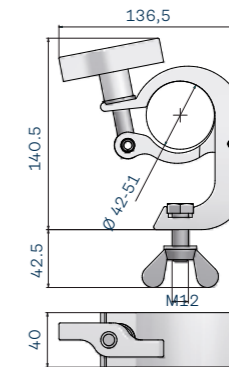

ACL5103C

Truss clamp LIC4851
CL. LIFT. EYE swl 350 kg

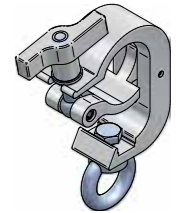
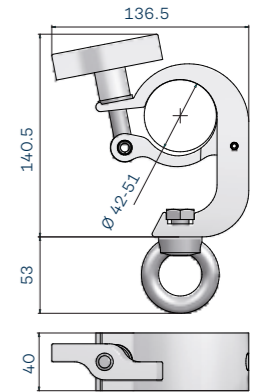

ACL51L040

Truss clamp LIC3851
OP. 28 BUSHING swl 360 kg

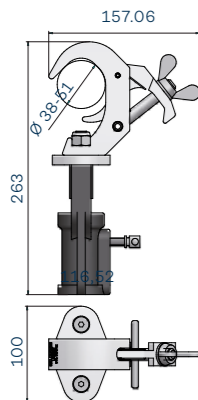

ACL51L050

Truss clamp LIC3851
OP. 28 SPIGOT swl 360 kg

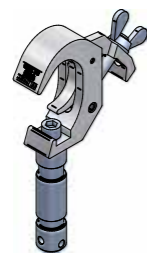
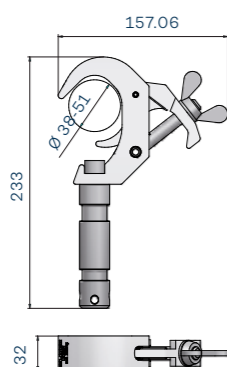

ACL51L060

Truss clamp LIC3851
OP. 16 SPIGOT swl 360 kg

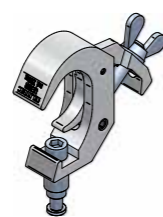
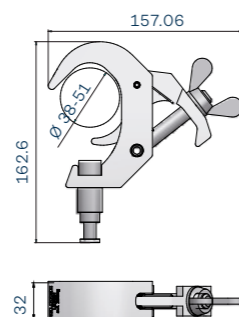

ACL51L100

Truss clamp LIC3851
OP. 16 - 28 BUS. swl 360 kg

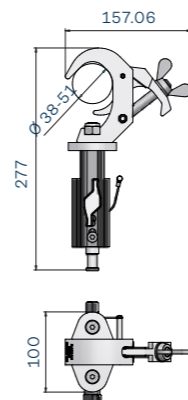

ACL51L04C

Truss clamp LIC4851
CL. 28 BUSHING swl 350 kg

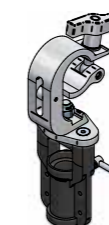
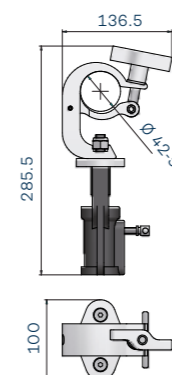

ALI51L05C

Truss clamp LIC4851
CL. 28 SPIGOT swl 350 kg

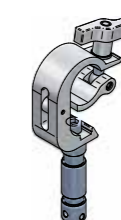
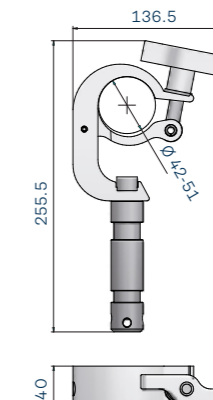

ACL51L10C

Truss clamp LIC4851
CL. 16 - 28 BUS. swl 350 kg

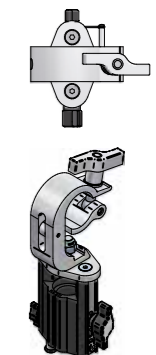
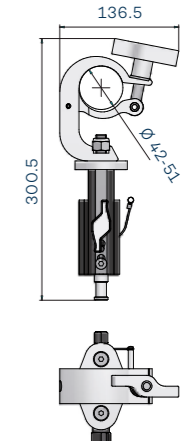

Clamps line

LIC3851 identifies a clamping range of products. This line includes all “the lighting clamps” to hang luminaires onto trusses with tubes with a diameter from 38 to 51 mm. Lighting clamps are all supplied with M12 wing nuts.

Accessories

HCLK001

Truss clamp ADAPTER 28 SPIGOT
M - M10

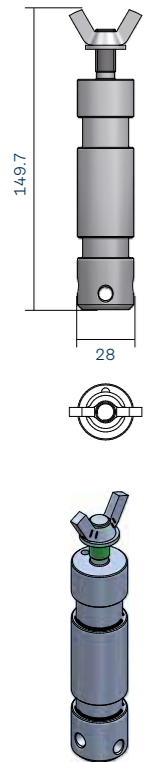

ASUPL001

CL. 28 BUSHING

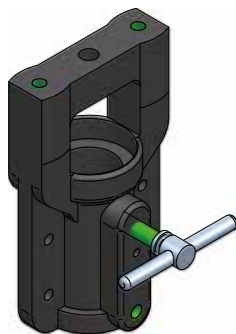

HCLK002

Truss clamp ADAPTER 16 SPIGOT
M - M10

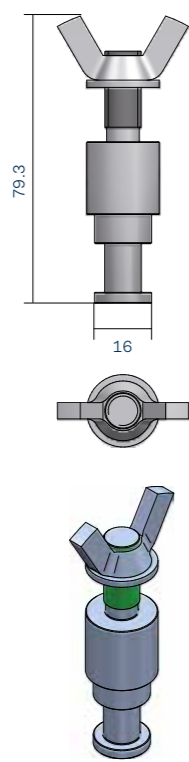

ASUPL002

CL. 16 - 28 BUSHING

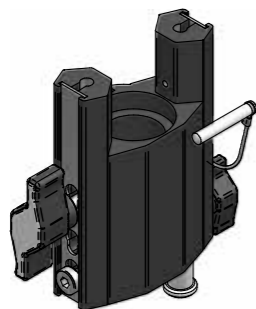

H Frame

It is a universal truss accessory that gives you the means to hang up to 180 kg of moving lights on horizontal truss tubes.

Due to its modularity, you can connect them together piece by piece to achieve the length you require.

Connection to your truss segments is carried out using a truss clamp and half spigot system. Additional safety is achieved with a special slot in the frame tube where a steel cable can be attached.

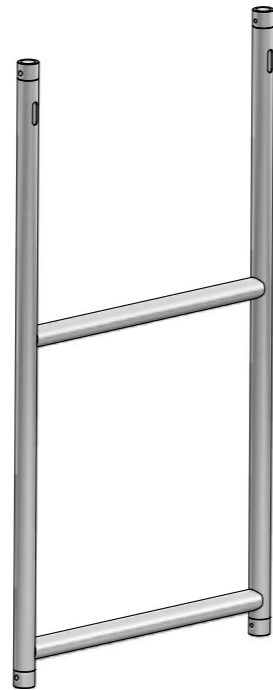

FD80150Z1

HD Flat truss L=150 cm with bushing
Extruded tube \varnothing 50 x 3 mm
EN AW-6082 T6

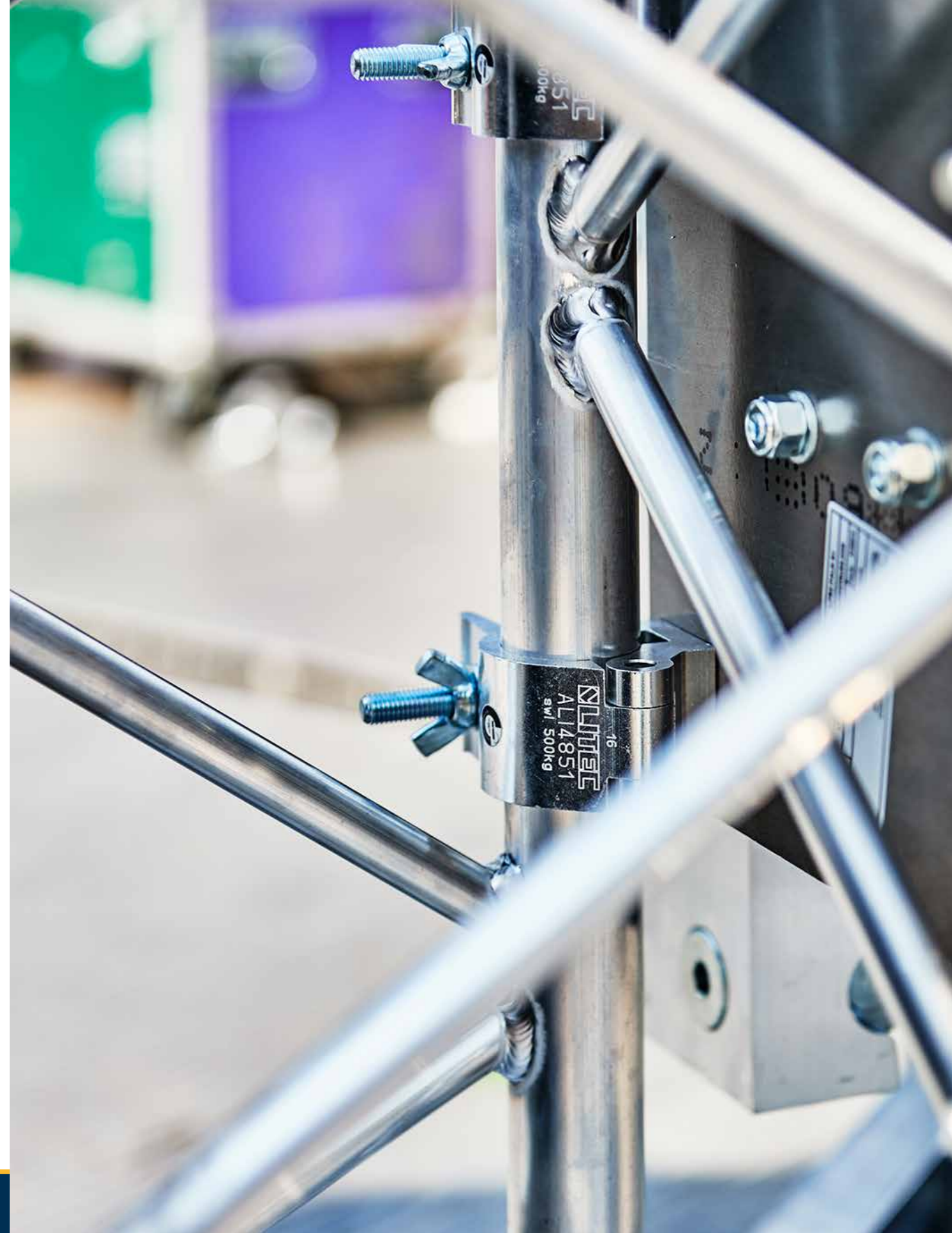

Rigging Accessories

High quality, extreme safety

LITEC offers a vast range of rigging accessories for lifting, fixing and anchoring structures, supplying the best-suited products for installations.

Steel wire ropes	16
Roundslings	17
Belt ratchets	18
Anchoring	19
Hardware	20

Steel wire ropes



216-wire metal core ropes with end eyes, oversized thimbles and conical ferrules. Available with 1 or 2-ton SWL/WLL* capacities. Colour coded thimbles to facilitate a length identification and oversized – 16 mm wire – to permit an easy introduction of a 4.75 ton shackle.

- Thimbles two-sizes bigger than the rope
- Talurit-type conical ferrules
- Metal core
- Ferrules are marked with the lot reference number, capacity and rope diameter.

Tecnical specification RGSW

2 models	→	1 or 2 tons
2 versions	→	pure rope or rope sheath
9 sizes	→	from 0.75 to 12 metres
Safety factor	→	5:1

Thimble colour	Rope length	Pure rope
orange	→ 0.75 metres	RGSW 1075
red	→ 1.50 metres	RGSW 1150
pink	→ 2.00 metres	RGSW1200
white	→ 3.00 metres	RGSW 1300
light blue	→ 4.00 metres	RGSW 1400
blu	→ 6.00 metres	RGSW 1600
yellow	→ 9.00 metres	RGSW 1900
brown	→ 10.00 metres	RGSW 11000
green	→ 12.00 metres	RGSW 11200

1000 KG WLL / Ø ROPE 10 mm

Pure rope	Rope with sheath	Rope with sheath
RGSW 2075	RGSWC 1075	RGSWC 2075
RGSW 2150	RGSWC 1150	RGSWC 2150
RGSW 2200	-	-
RGSW 2300	RGSWC 1300	RGSWC 2300
RGSW 2400	-	-
RGSW 2600	-	-
RGSW 2900	-	-
RGSW 21000	-	-
RGSW 21200	-	-

2000 KG WLL / Ø ROPE 14 mm

Thimbles are fixed to the ends of our steel wire ropes with Talurit-type conical ferrules; the ferrules are fitted by cold pressing in compliance with European standards EN 13411 and DIN 3093.

The inspection hole on the ferrule is useful for the rope manufacturer for tests and inspections, but not necessarily for the end user (EN 13411-3).

It is remotely possible for a rope to slip from a ferrule, however before this happens the rope thimbles will already have changed shape. Regular checking of the thimble shape together with rope strand condition tests are an excellent guarantee of safety.

*SWL/WLL = Safe Working Load / Working Load Limit

6 strand rope with 26 wires each total 216 wires.

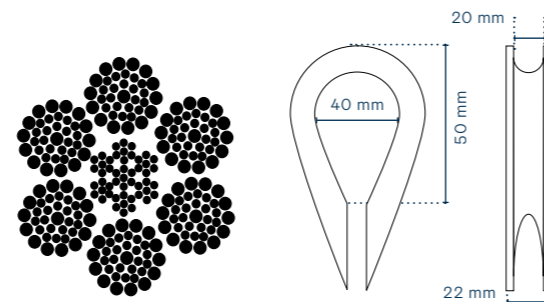

Roundslings

Essential for lifting and hanging loads and structures



RGRS polyester roundslings

Black endless polyester slings. Useful for creating basket or choke bridles on structures and trusses.

- Endless slings
- Black polyester anchoring 100%
- Sheath made in a highly abrasion-resistant material

Tecnical specification RGRS

2 models	→	1.0 and 2.0 tons
6 sizes	→	from 0.5 to 3 metres in diameter
Safety factor	→	7:1

Code	1000 kg	Code	2000 kg
RGRS101	0.5 m EWL	RGRS201	0.5 m EWL
RGRS102	1.0 m EWL	RGRS202	1.0 m EWL
RGRS103	1.5 m EWL	RGRS203	1.5 m EWL
RGRS104	2.0 m EWL	RGRS204	2.0 m EWL
RGRS105	2.5 m EWL	RGRS205	2.5 m EWL
RGRS106	3.0 m EWL	RGRS206	3.0 m EWL



RGSS soft steel slings

Steel wire loop sling protected with black reinforced sheath abrasion-resistant. When installed, it does not need any additional safety device.

- High heat resistance
- Core: 25 loops of zinc plated 2mm wire rope
- Inspection gap permits a complete inspection of the wire rope
- They comply with the Standards EN 13414 1-3, EN 1492-2, BGV-C1

Tecnical specification RGRSS

1 models	→	2 tons
3 sizes	→	from 1 to 3 metres in diameter
Safety factor	→	5:1

Code	2000 kg
RGSS202	1 m EWL*
RGSS203	1.5 m EWL
RGSS204	2 m EWL
RGSS206	3 m EWL

MODE FACTOR		WLL* capacity of a roundsling		
		1000 kg	2000 kg	
⌋	Direct tension	1.0	1000	2000
⌋	Choke	0.8	800	1600
⌋	Up to 7°	2.0	2000	4000
⌋	Over 7° up to 45°	1.4	1400	2800
⌋	Over 45° up to 60°	1.0	1000	2000
⌋	Over 7° up to 45°	0.7	700	1400
⌋	Over 45° up to 60°	0.5	500	1000

The MODE FACTOR, i.e. the way a roundsling is used, should always be considered when calculating rigging capacities. For this reason and owing to their susceptibility to shear, roundslings have a coefficient of 7 (EN 1492-2).

Do not tie or connect roundslings to each other since this reduces their actual capacity in an uncontrollable way.

*EWL= Effective Working Length

*WLL= Working Load Limit

Belt ratchets

Anchoring consisting of 35 and 50mm polyester belts for fastening and safety. Belt ratchets are often used to tension roof system sheets.



RGBR black belt ratchets 50 mm (claw hook)

- Belt ratchet and hooks made in tropicalized galvanized steel
- Belt in 100% polyester, a highly abrasion-resistant material
- PVC plate with WLL

Code	WLL	Width	EWL
RGBR55006GH	5000 kg *	50 mm	6 m
RGBR55008GH	5000 kg *	50 mm	8 m
RGBR55012GH	5000 kg *	50 mm	12 m

* Only if used a ring

Tecnical specification RGBR

3 models	→ 50 mm
Sizes	→ 6 – 8 – 12 m (3 and 6 m available until stocks are exhausted)
Safety factor	→ 2:1



RGBR2 black belt ratchets 35 mm

- Belt ratchet and hooks made in tropicalized galvanized steel
- Belt in 100% polyester, a highly abrasion-resistant material
- PVC plate with WLL

Code	WLL	Width	EWL
RGBR23502K	2000 kg	35 mm	2 m
RGBR23508K	2000 kg	35 mm	8 m

Tecnical specification RGBR

2 models	→ 35 mm
Sizes	→ 2 – 8 metres
Safety factor	→ 2:1



RGBR5 black belt ratchets 50 mm

- Belt ratchet and hooks made in tropicalized galvanized steel
- Belt in 100% polyester, a highly abrasion-resistant material
- PVC plate with WLL

Code	WLL	Width	EWL
RGBR55008G	5000 kg	50 mm	8 m
RGBR55012G	5000 kg	50 mm	12 m

Tecnical specification RGBR

2 models	→ 50 mm
Sizes	→ 8 – 12 metres
Safety factor	→ 2:1

Anchoring

These products are ideal for adjusting anchoring and bracing cables.



Tecnical specification RGTB

2 models	→ from 1.0 to 2.36 tons
Excursion	→ 17.1 cm
Safety factor	→ 5:1

RGTB turnbuckles

Zinc-plated with forked ends for adjusting anchoring and bracing cables.

- Belt ratchet and hooks made in tropicalized galvanized steel
- Belt in 100% polyester, a highly abrasion-resistant material
- PVC plate with WLL

Code	Description	Max. closing	Max. opening	Excursion
RGTB10	1/2" turnbuckle 1 ton-414/585 mm	41.4 cm	58.5 cm	17.1 cm
RGTB20	3/4" turnbuckle 2,36 ton-540/640	51 cm	64 cm	14 cm



Tecnical specification RGBRT

2 models	→ 2.0 tons
Variable excursion	→ from 0 to 4 m
Safety factor	→ 2:1

RGBRT pull lash straps

Belt tensioning ratchet with adjustable zinc plated hooks. Made with 50 mm black polyester belt, it has a 2 ton WLL.

- Chromo-plated ratchet with aluminium handle
- High abrasion resistance belt in polyester
- 2.5 ton WLL

Code	RGBRT
RGBRT25002H	Pull Lash Strap – 2.5 ton – 2 m with swivel hook
RGBRT25004H	Pull Lash Strap – 2.5 ton – 4 m with swivel hook



Tecnical specification RGCC

2 models	→ 8 mm diameter
EWL	→ 2 – 3 m
Safety factor	→ 4:1

RGCC chain clutch sling

Chain adjustable sling, with safety latch chain clutch.

- 8 mm black DIN chain
- 2 ton master link ending
- 2 ton latch hook ending

Code	WLL	EWL
RGCCS20002MH	2000 kg	2 m
RGCCS20003MH	2000 kg	3 m



RGLCH anchoring chain 8 mm

It is a chain specifically thought to do wind bracing on truss systems thus guaranteeing the highest safety. It cannot be used for lifting loads. It is available in 2 lengths, 2 mt and 4 mt.

- DIN 763 Chain
- Grade 3
- Steel material.

Code	EWL
RGLCH085402	2 m
RGLCH085404	4 m

Tecnical specification RGLCH

2 models	→ 2x52 mm
EWL	→ 2 – 4 m
Weight/m	→ 1100 gr

Hardware

The very best equipment for safe rigging.



RGBC beam clamps

Clamps suitable for hanging hoists and other lifting devices on I and H girders and beams.

- Made in steel
- Black powder coated
- Adjustable to fit a wide range of flange widths, until 320 mm
- Reduced overall vertical height
- Marked for traceability with serial number and CE

Code	Beam Clamp	WLL	Truss Length	Weight
RGBC1B	WLL 1000 kg	1000 kg	75/230 mm	4 kg
RGBC2B	WLL 2000 kg	2000 kg	75/230 mm	5 kg
RGBC3B	WLL 3000 kg	3000 kg	80/320 mm	9 kg

Tecnical specification RGBC

3 models	→ from 1 to 3 tons
Maximum excursion	→ 1/2 ton: 284 mm; 3 ton: 365 mm
Safety factor	→ 4:1



SC60 safety cable

Tecnical specification SC60

Wire	3 mm
WLL capacity	30 kg

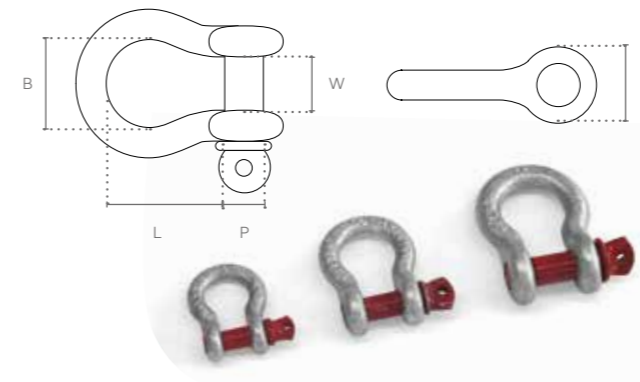

Tecnical specification RGSH

3 models	→ from 2 to 4.75 tons
Weight	→ LT RGSH200C 0.34 kg LT RGSH325C 0.59 kg LT RGSH475C 1.021 kg
Safety factor	→ 5:1

RGSH omega shackles with threaded pin

3 kinds of zinc-plated omega shackles are available for anchoring connections and ropes.

- Zinc-plated steel omega shackles
- Red screw pin
- Each shackle is marked with its size in inches and millimetres and its WLL load limit

Code	size R	size B	size P	size W	size L
RGSH200C	34.5 mm	32 mm	16 mm	22.0 mm	51.0 mm
RGSH325C	40.0 mm	43 mm	19 mm	27.0 mm	64.0 mm
RGSH475C	47.0 mm	51 mm	22 mm	31.0 mm	76.0 mm

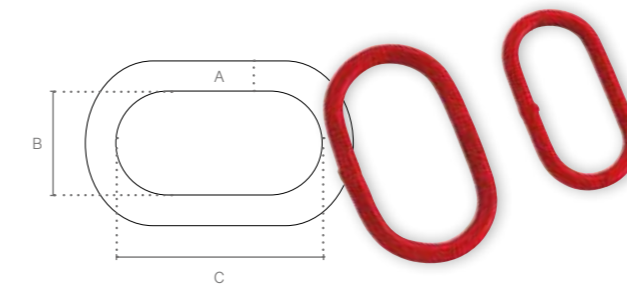

Tecnical specification RGML

2 models	→ 2 and 3.15 tons
Weight	→ 0.53 and 0.92 kg
Safety factor	→ 4:1

RGML master links

Two master link models (2.4 and 3.15 tons) are available for anchoring connections using shackles.

Code	Master link	size A	size B	size C
RGML2120C	WILL 2.120 kg	16 mm	69 mm	118 mm
RGML3150C	WILL 3.150 kg	18 mm	77 mm	135 mm



Cablecross

Reliable cable protection

They are designed to meet the increasing need of a safe way of laying and protecting cables, hoses and ducts.

They are patented models and their continuous development has made them superior quality products.

They guarantee:

- Tidy laying of cables and ducts;
- Separated channels.
- They can contain plugs and sockets;
- They do not obstacle movement in public areas;
- They can be easily crossed by small wheels;
- They are extremely resistant to heavy vehicles crossing;
- They comply with safety regulations.

Cablecross 25HD

26

Cablecross 66HD

28

Cablecross 25HD



3-channel cable duct. It is the best solution for holding electrical wiring, telephonic and data cables, hydraulic lines, in offices, yards, trade centres, markets, camping places, live events, exhibition centres, military and public areas.

Technical specifications

Use	→	pavement
Reaction to Fire:	→	CLASS 1 in accordance with the uni 9174 + uni 8457
It complies with the EEC 73/23 directives regarding the low voltage electrical equipment		
It can be crossed by heavy vehicles according to its maximum roll-on load: 170N/cm ²		
Excellent resistance to solvents, acids, oils and atmospheric agents		
Max. operating voltage:	→	1000v c.a. - 1500 v c.c.
Insulation resistance:	→	29.5 GΩ
Protection:	→	IP30xc (according to CEI EN 60529-9/92 regulations)
Surface hardness:	→	90-98 (shore A)
Body:	→	semi-rigid expanded polyurethane & auto-peeling moulded extremely resistant against cuts or incisions
Top lid material:	→	polycarbonate / PC (very flexible and resistant)
The lid is fixed to the base by means of a moulded tug hinge (velcro ®)		

Cablecross code

Cablecross code	Description
CC25HD	→ CC25HD Cablecross - 3 channel
CC25HDX4	→ 4-way cross CCH25HD corner
CC25LHD	→ CC25HD Cablecross lid
CC25LHDX4	→ 4-way cross CC25HD corner lid
CCSTM	→ Strap for lid – M Size
CC25LOGO	→ CC25HD Logo Personalization

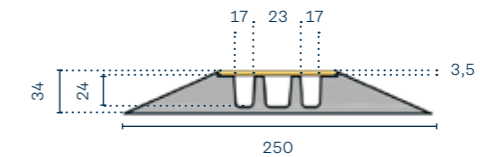

Cablecross 25HD Code CC25HD

Dimensions	→	250 x 34 x 1000 mm
Number of Cable-cross per package	→	5
Weight	→	2.85 kg
Lid weight	→	0.40 kg

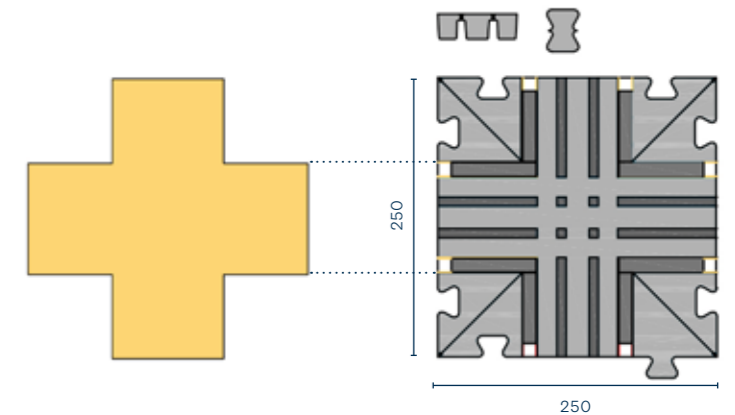
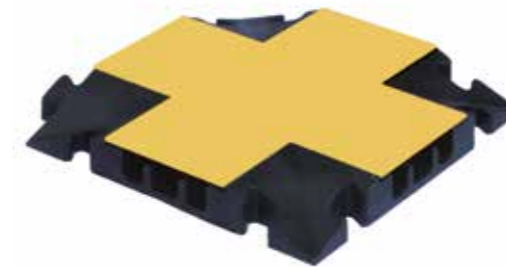
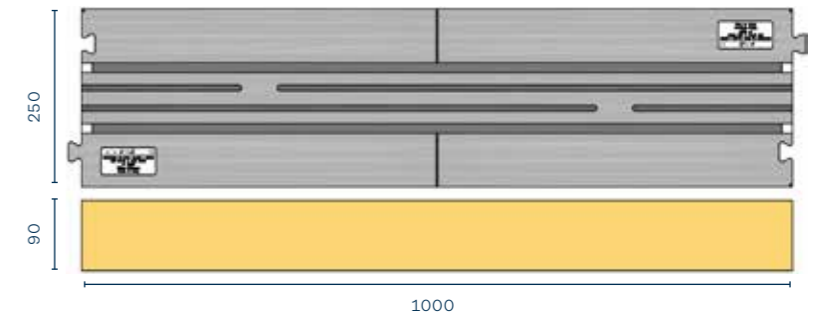

4-Way Cross Corner Code CC25HDX4

Dimensions	→	250 x 34 x 250 mm
Number of Cable-cross per package	→	1
Weight	→	0.80 kg
Lid weight	→	0.20 kg

Cablecross 25HD

1. Rounded angles - no steps.
2. Moulded Velcro (not glued).
3. Ergonomic built-in handle with rounded edges.
4. Prearrangement for ground fastening.

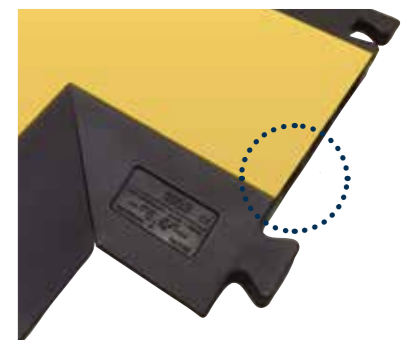

Cablecross 66HD



3-channel cable duct. It is the best solution for holding electrical wiring, telephonic and data cables, hydraulic lines, in offices, yards, trade centres, markets, camping places, live events, exhibition centres, military and public areas.

Use	→ pavement
Reaction to Fire:	→ CLASS 1 in accordance with the uni 9174 + uni 8457
It complies with the EEC 73/23 directives regarding the low voltage electrical equipment	
It can be crossed by heavy vehicles according to its maximum roll-on load: 170N/cm ²	
Excellent resistance to solvents, acids, oils and atmospheric agents	
Max. operating voltage:	→ 1000v c.a. - 1500 v c.c.
Insulation resistance:	→ 29.5 GΩ
Protection:	→ IP30xc (according to CEI EN 60529-9/92 regulations)
Surface hardness:	→ 90-98 (shore A)
Body:	→ semi-rigid expanded polyurethane & auto-peeling moulded extremely resistant against cuts or incisions
Top lid material:	→ polycarbonate / PC (very flexible and resistant)
The lid is fixed to the base by means of a moulded tug hinge (velcro ®)	

Cablecross code	Description
CC66HD	→ CC66HD Cablecross - 3 channel
CC66HDC30	→ 30° 2-way cross CCH66HD corner
CC66HDT3	→ 3-way "T" CC66HD Corner
CC66LHDC	→ CC66HD Cablecross Lid
CC66LHDT3	→ CC Strap for lid - M Size
CC66LHDC30	→ CC25HD Logo Personalization
CC66LHDC	→ 4-way cross CC25HD corner lid
CC66LHDT3	→ CC Strap for lid - M Size
CC66LHDC30	→ CC25HD Logo Personalization

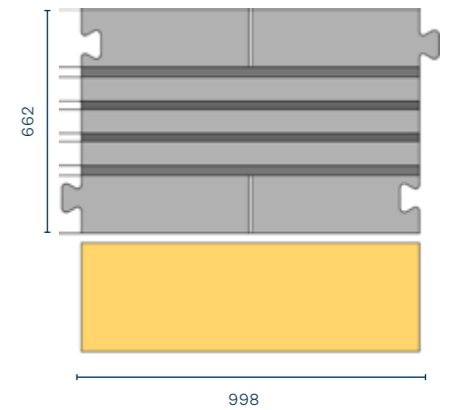
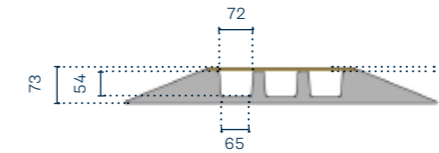

Cablecross 66HD Code CC66HD	
Dimensions	→ 662 x 73 x 1000 mm
Number of Cable-cross per package	→ 2
Weight	→ 12.8 kg
Lid weight	→ 1.5 kg

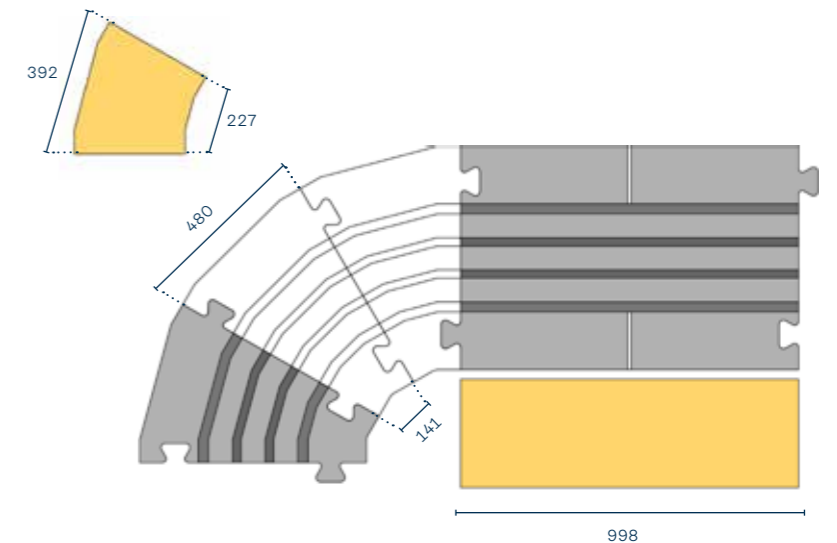
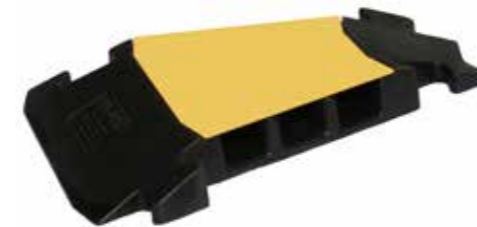

30° 2-WAY Corner Code CC66HDC30	
Dimensions	→ 370 x 73 x 375 mm
Number of Cable-cross per package	→ 1
Weight	→ 3.7 kg
Lid weight	→ 0.40 kg

Cablecross 66HD

1. Rounded angles - no steps.
2. Moulded Velcro (not glued).



3. 3-way "T" CORNER



4. Prearrangement for ground fastening.

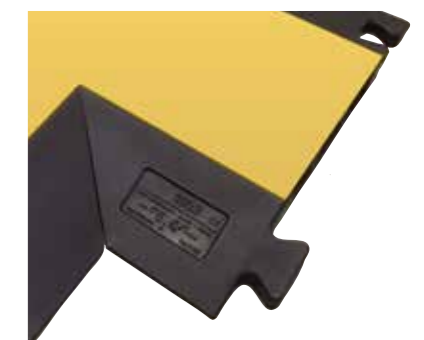



Area Four Industries Italia S.r.l.

Via Martin Luther King 70, 31032
Casale sul Sile (TV), Italy

T +39 0422 997 300
F +39 0422 997 399

www.litectruss.com
www.litectruss.it

info@litectruss.com



Follow us: [@litectrussing](https://www.instagram.com/litectrussing)

